



## Emergency Procedures for SICE Buildings

### TORNADO

During a tornado warning you should take shelter in the designated tornado shelter areas in the building you are in. Luddy Hall has multiple tornado shelter areas, and you should consult the **Evacuation Map** for more details. Please consult the **Evacuation Map** for Luddy AI as well. The tornado shelters in the Informatics Complex are the Info East Basement and Info West Basement. People in the Info Connector should go to the Info West Basement.

### FIRE & EVACUATION

During a fire alarm or evacuation of one of the SICE buildings, you should immediately exit by the nearest stairway or door and move well away from the building. Try to close any doors as you leave. *Make sure to look for traffic before crossing streets.* The map on the right shows areas where you can congregate after evacuation around the SICE buildings. Do not re-enter the building until you are told to by an emergency responder or staff member.

### MEDICAL EMERGENCIES

The priority is to dial 911, and to give clear information to the dispatcher on the location and nature of the problem. Automated External Defibrillators (AEDs) are kept in each of the buildings – see the table for exact locations.

### GETTING HELP

In an emergency there are several ways to get help, including dialing 911, pulling the fire alarm (in the case of a fire only), and asking a SICE facilities/IT staff member for help (they are the ones carrying two-way radios). Your priority should always be to ensure you are in a safe location, and then to call 911.

TORNADO	
LUDDY HALL	SEE MAP
LUDDY AI	SEE MAP
INFO WEST	BASEMENT
INFO EAST / CONNECTOR	BASEMENT

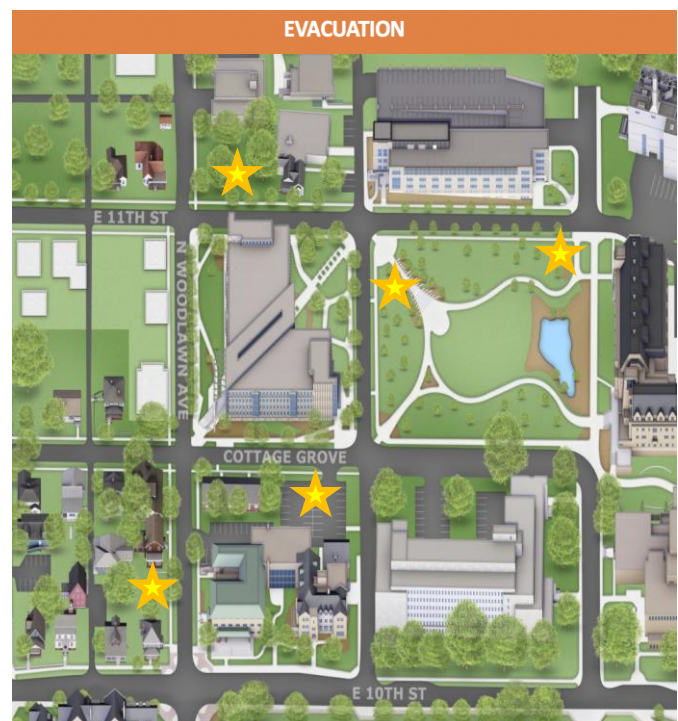

AED LOCATIONS	
LUDDY	FLOORS 1-4 BY KITCHEN. BASEMENT ON SOUTH WALL
LUDDY AI	FLOOR 1 BY WEST LOBBY ELEVATOR AREA FLOOR 3 BY EAST LOBBY ELEVATOR AREA
INFO WEST	BY ELEVATOR ON GROUND FLOOR
INFO EAST	BY ELEVATOR ON GROUND & 3RD FLOOR